

Rev	AWO #	Description	Date	Appr
-		RELEASED	9/20/04	

APPROVED: _____
 DATE: _____ TITLE: _____

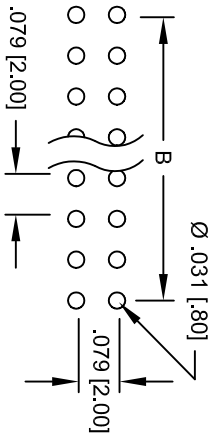

Recommended
PC Board layout

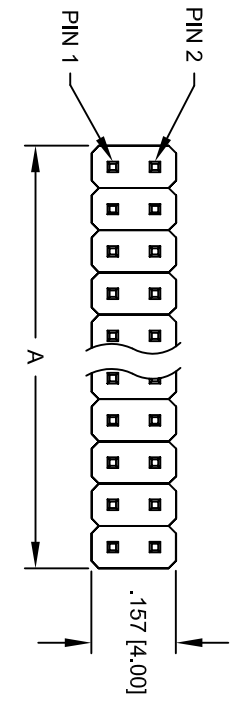
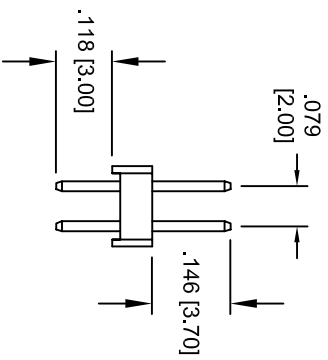
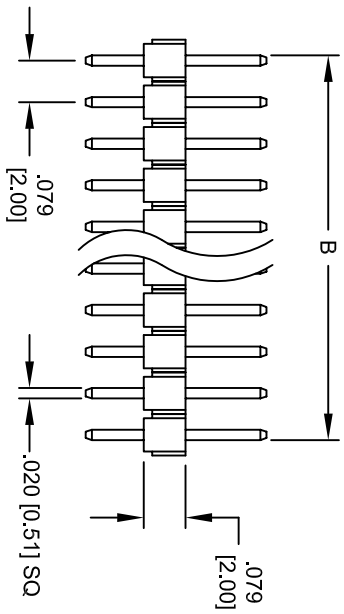

A = .079" [2.00] x No. of positions
 B = .079" [2.00] x No. of spaces

SPECIFICATIONS:

- Material: Insulator: PBT, rated UL 94V-0
- Insulator color: Black
- Contacts: Brass
- Plating: Tin over Copper underplate overall
- Electrical: Operating voltage: 250 VAC max
- Current rating: 1 Amp max
- Contact resistance: 20 mohms max
- Insulation resistance: 5000 Mohms min @ 500 VDC
- Dielectric withstanding voltage: 1000 VAC for 1 minute
- Temperature Rating: Operating temperature: -55°C to +105°C

ADAM TECH

909 Rahway Avenue, Union, NJ 07083
 Phone: 908-687-5000 Fax: 908-687-5710

SINGLE ROW PIN HEADER, .079" [2.00mm] PITCH, TIN PLATED, 2 TO 80 PINS

UNLESS OTHERWISE SPECIFIED ALL DIMENSIONS ARE INCHES [MM]		TOLERANCES: EXCEPT AS NOTED	
.X	± .10	ØX	± .10
.XX	± .020	ØXXX	± .015
.XXX	± .015	ØXXXX	± .010
DRAWN		SS	9/20/04
CHECKED			
APPROVED			
REF:	SIZE	PART NO.	REV.
	X	2PH2-XX-1A	-
SCALE:	NTS	SHEET	1 OF 1