

Rev	AWO #	Description	Date	Appr
-		RELEASED	11/29/10	

APPROVED: _____
 DATE: _____ TITLE: _____

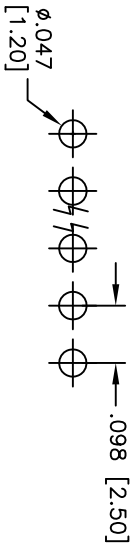
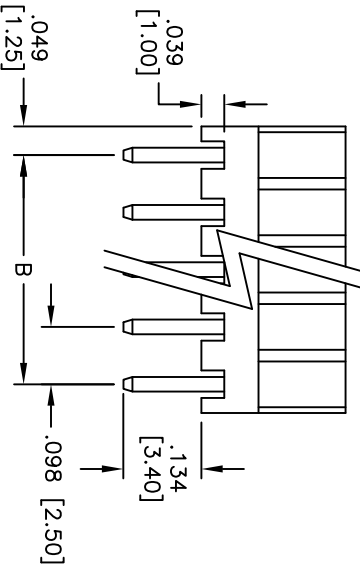
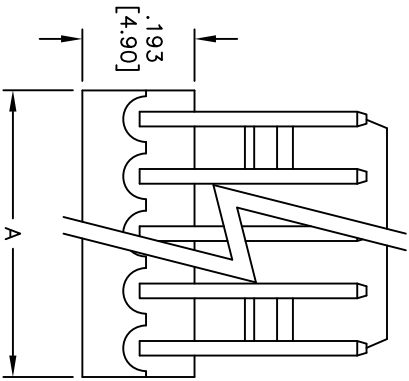
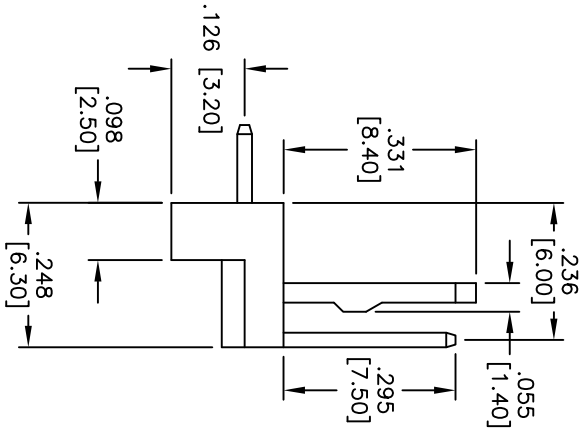

RECOMMENDED PCB LAYOUT

SPECIFICATIONS:
 Material: Nylon 66, rated UL 94V-0
 Insulator color: White
 Contacts: Brass
 Plating: Tin over Copper underplate overall
 Electrical: Tin over Copper underplate overall
 Operating voltage: 250 VAC max
 Current rating: 3 Amps max
 Dielectric withstanding voltage: 1,500 VAC for 1 minute
 Temperature Rating: Operating temperature: -40°C to +105°C
 Environmental: Lead free, RoHS compliant
 Recommended soldering temp: 235°C for 5 seconds

Positions: 2 thru 20
 A = .098 [2.50] x No. of Positions
 B = .098 [2.50] x No. of Spaces

UNLESS OTHERWISE SPECIFIED
 ALL DIMENSIONS ARE INCHES [MM]
 TOLERANCES: EXCEPT AS NOTED
 INCHES HOLEES
 .X ± .10 ØXX ± .10
 .XX ± .020 ØXXX ± .015
 .XXX ± .015 ØXXXX ± .010
 APPROVALS DATE

ADAM TECH

909 Railway Avenue, Union, NJ 07083
 Phone: 908-687-5000 Fax: 908-687-5710

TITLE: .098 [2.50] LOCKING HEADER
 RIGHT ANGLE, PCB, TIN PLATED

DRAWN	DY	11/29/10	SIZE	PART NO.	REV.
CHECKED			X	25LHA-XX-TRA-V0	
APPROVED			REF: S00123T	SCALE: NTS	SHEET 1 OF 1