

APPROVED: \_\_\_\_\_  
 DATE: \_\_\_\_\_ TITLE: \_\_\_\_\_

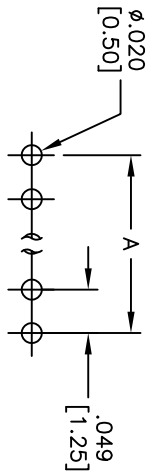
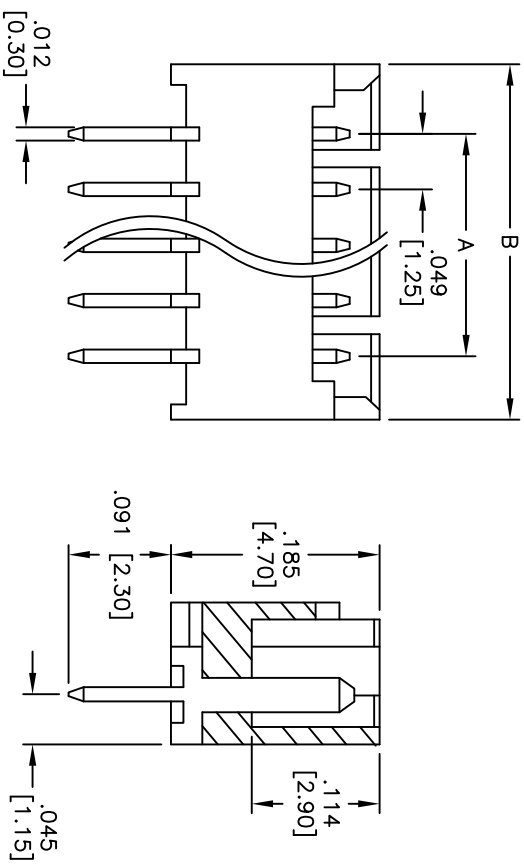
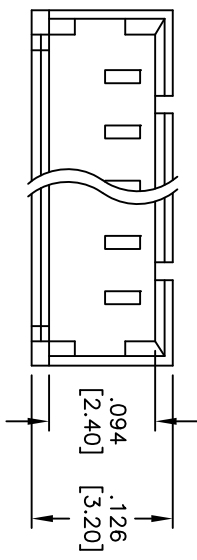

RECOMMENDED PCB LAYOUT

CIRCUITS	DIM A	DIM B
2	.049 [1.25]	.169 [4.30]
3	.098 [2.50]	.217 [5.50]
4	.148 [3.75]	.268 [6.80]
5	.197 [5.00]	.315 [8.00]
6	.246 [6.25]	.366 [9.30]
7	.295 [7.50]	.413 [10.50]
8	.344 [8.75]	.465 [11.80]
9	.394 [10.00]	.512 [13.00]
10	.443 [11.25]	.563 [14.30]
11	.492 [12.50]	.610 [15.50]
12	.541 [13.75]	.661 [16.80]
13	.591 [15.00]	.709 [18.00]
14	.640 [16.25]	.760 [19.30]
15	.689 [17.50]	.807 [20.50]

**SPECIFICATIONS:**  
 Material: Nylon 6T, rated UL 94V-0  
 Insulator color: Natural  
 Contacts: Phosphor Bronze  
**Plating:**  
 Tin over Copper underplate overall

**Electrical:**  
 Operating voltage: 125 VAC, DC  
 Current rating: 1A AC, DC  
 Insulation resistance: 100 Mohms min  
 Dielectric withstanding voltage: 250 VAC for 1 minute  
**Temperature Rating:**  
 Operating temperature: -40°C to +85°C  
 Environmental:  
 Lead free, RoHS compliant.  
 Recommended soldering temp: 260°C. for 5 sec.



Rev	AWO #	Description	Date	Appr
-		RELEASED	01/17/07	
A		REDRAWN	1/29/10	

UNLESS OTHERWISE SPECIFIED ALL DIMENSIONS ARE INCHES [MM]		TOLERANCES: EXCEPT AS NOTED	
INCHES	± .10	HOLDERS	± .10
.XX	± .020	ØXX	± .015
.XXX	± .015	ØXXX	± .010
APPROVALS		DATE	
DRAWN	BW	01/17/07	
CHECKED			
APPROVED			
TITLE		SIZE	PART NO.
ADAM TECH		X	125SH-A-XX-TS
909 Railway Avenue, Union, NJ 07083		REF: S00016T	SCALE: NTS
Phone: 908-687-5000 Fax: 908-687-5710			SHEET 1 OF 1
VERTICAL, STRAIGHT, DIP TYPE		REV.	A