

MBC-B
2.5mm RIGHT ANGLE SMT

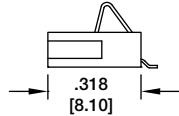

MBC-B-4

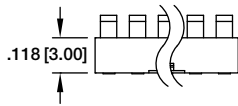

Recommended PCB Layout

POSITIONS AVAILABLE: 2, 3, 4 & 5
A = .098 [2.50] X NO. OF POSITIONS
B = .098 [2.50] X NO. OF SPACES

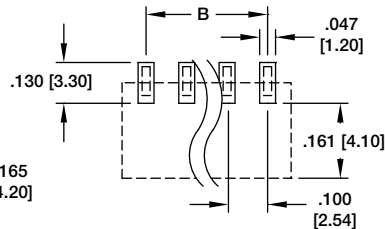
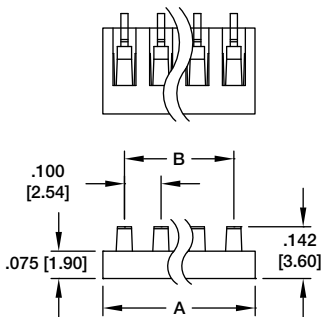

MBC-C
2.54mm RIGHT ANGLE SMT



MBC-C-4

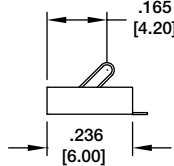

Recommended PCB Layout

POSITIONS AVAILABLE: 4 & 6
A = .100 [2.54] X NO. OF POSITIONS
B = .100 [2.54] X NO. OF SPACES

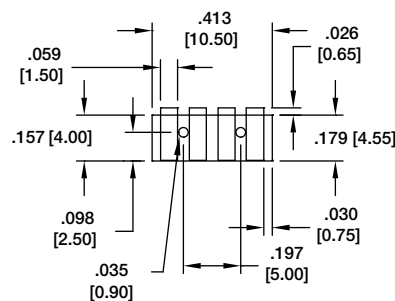
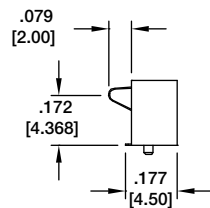
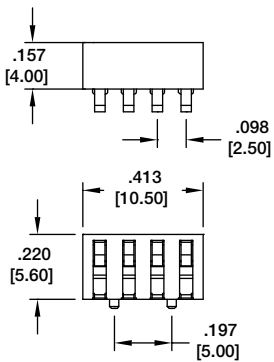

MBC-K-4
2.50mm VERTICAL SMT

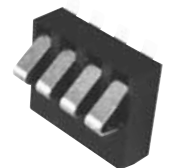

MBC-K-4

Recommended PCB Layout

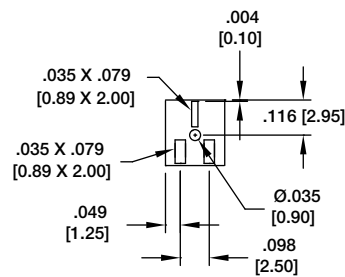
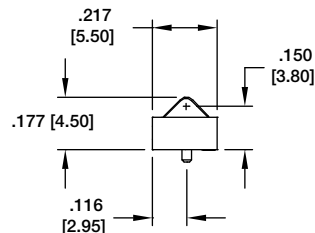
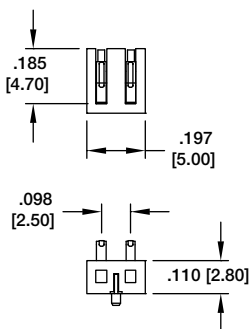

MBC-M-2
2.50mm VERTICAL SMT



MBC-M-2

Recommended PCB Layout