

#### ASJ-111

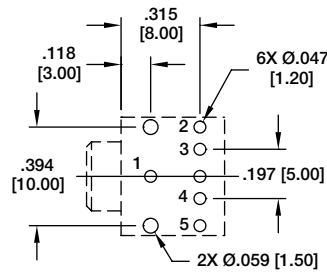

Recommended PCB Layout

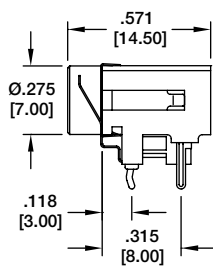
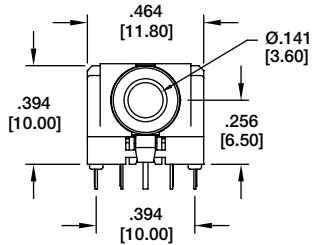

ASJ-111-1

ASJ-111-1	ASJ-111-1A

#### ASJ-112



ASJ-112-J

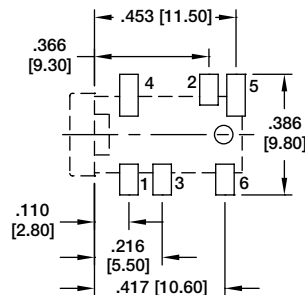
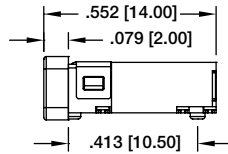
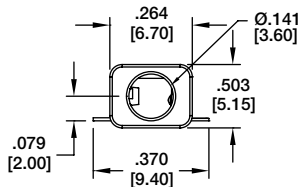

Recommended PCB Layout

ASJ-112-I	ASJ-112-J	ASJ-112-M
ASJ-112-A	ASJ-112-B	ASJ-112-D

#### ASJ-113



ASJ-113-B

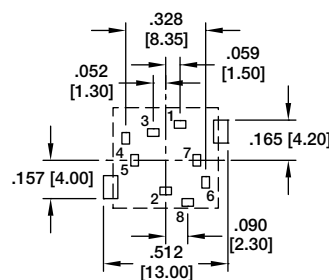
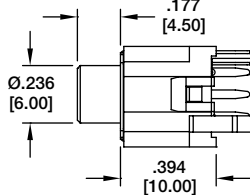
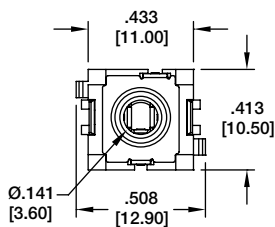

Recommended PCB Layout

ASJ-113-B	ASJ-113-D
ASJ-113-K	ASJ-113-W

#### MONO AUDIO PLUG

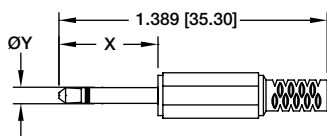

DIMENSION	X	Y
ASP-2.5-M	.468 [11.90]	Ø.098 [2.50]
ASP-3.5-M	.590 [15.00]	Ø.137 [3.50]

#### STEREO AUDIO PLUG 2 CHANNEL

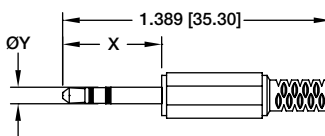

DIMENSION	X	Y
ASP-2.5-S	.468 [11.90]	Ø.098 [2.50]
ASP-3.5-S	.590 [15.00]	Ø.137 [3.50]

#### STEREO AUDIO PLUG 3 CHANNEL

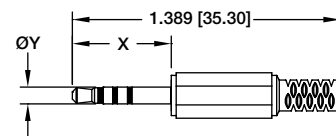

DIMENSION	X	Y
ASP-2.5-S3	.468 [11.90]	Ø.098 [2.50]
ASP-3.5-S3	.590 [15.00]	Ø.137 [3.50]