

ASJ-1

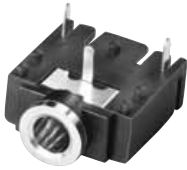

ASJ-1-3

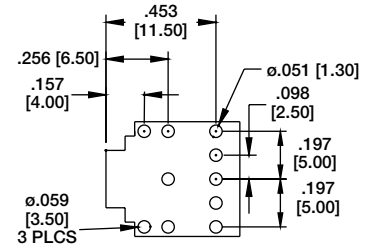
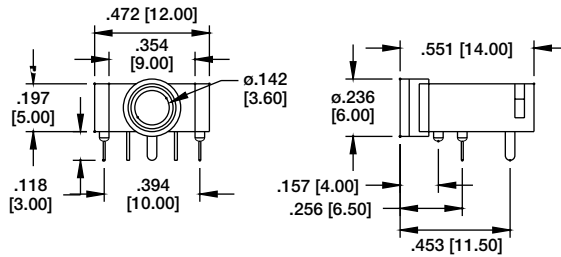

Recommended PCB Layout

ASJ-5



ASJ-5-4A

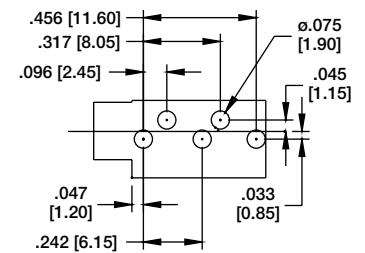
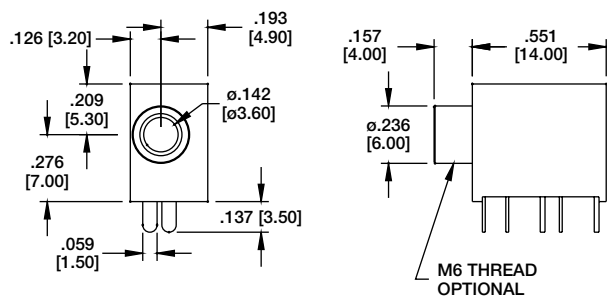

Recommended PCB Layout

ASJ-37



ASJ-37-5-M

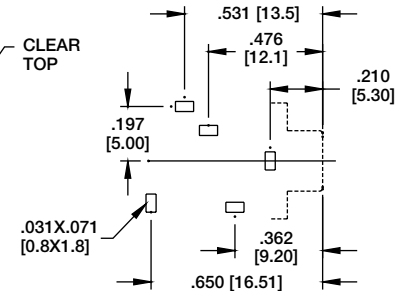
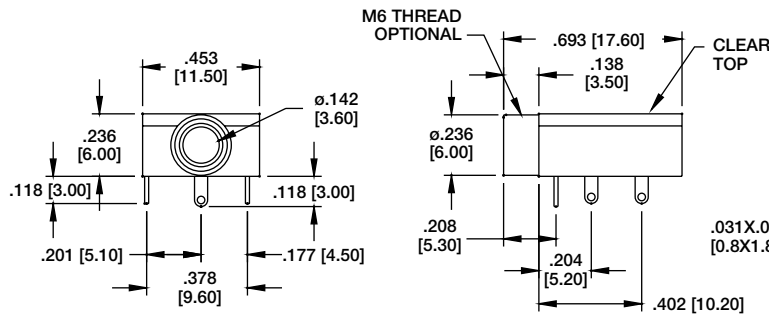

Recommended PCB Layout

ASJ-6



ASJ-6-5

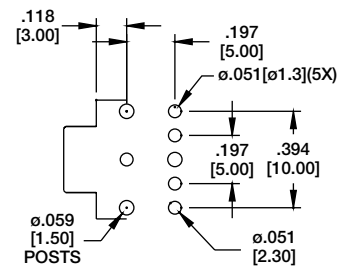
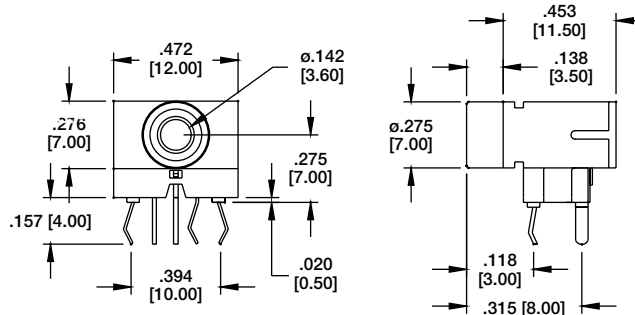

Recommended PCB Layout

CONTACT FORM	FORM 2	FORM 3	FORM 3A	FORM 4A	FORM 4B	FORM 5
SCHEMATIC						

ASJ-7



ASJ-7-5

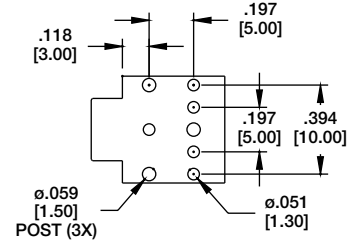
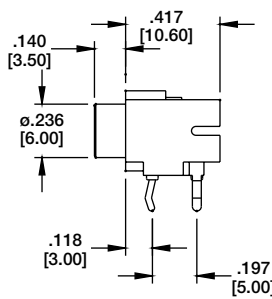
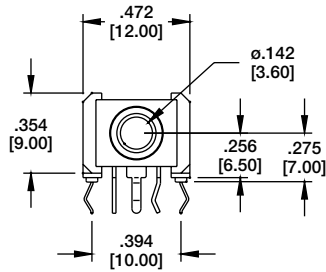

Recommended PCB Layout

ASJ-40



ASJ-40-4A

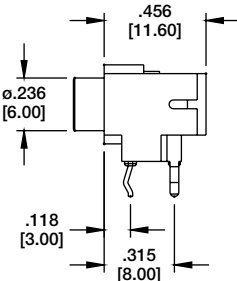
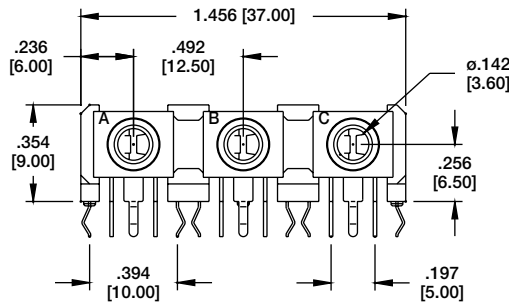

Recommended PCB Layout

ASJ-15



ASJ-15-4B

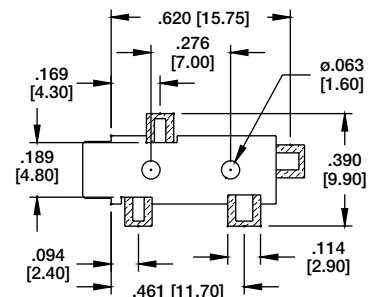
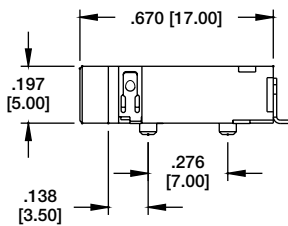
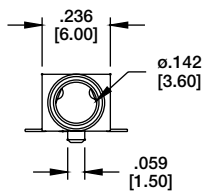

Recommended PCB Layout

ASJ-41



ASJ-41-5

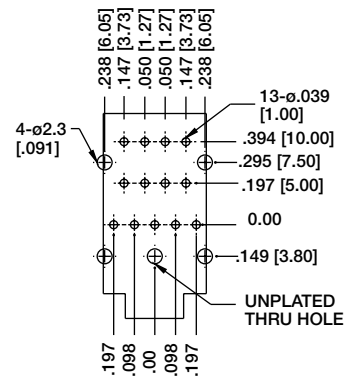
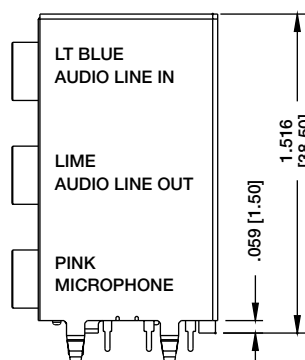
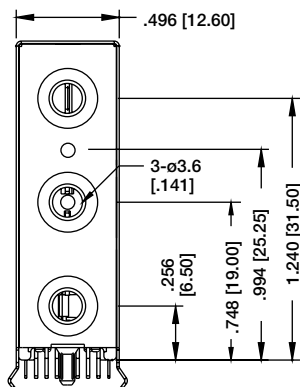

Recommended PCB Layout

ASJ-12



ASJ-12-5

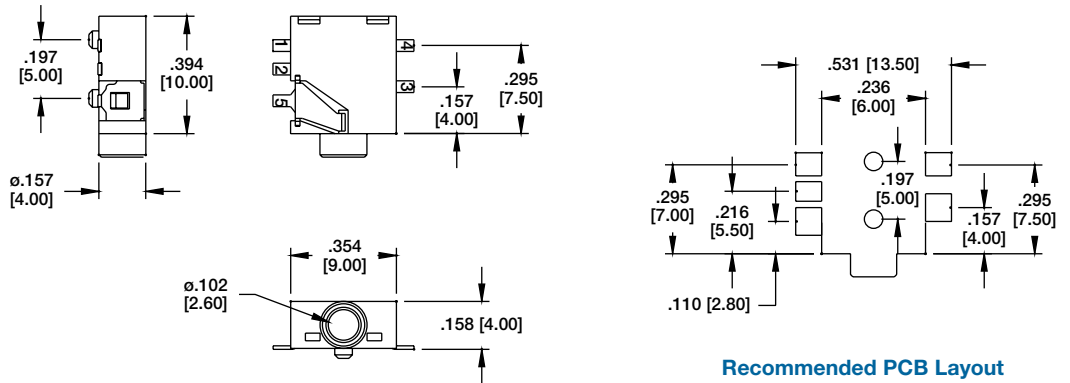

Recommended PCB Layout

ASJ-18



ASJ-18-4B

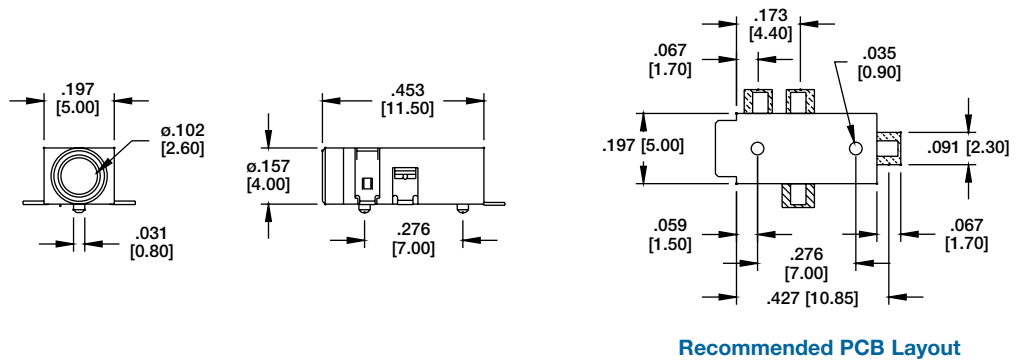

Recommended PCB Layout

ASJ-38



ASJ-38-5

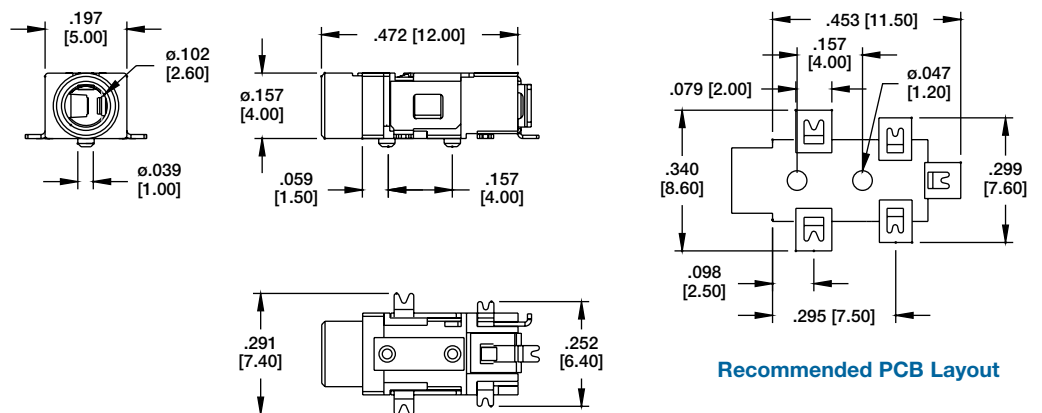

Recommended PCB Layout

ASJ-103

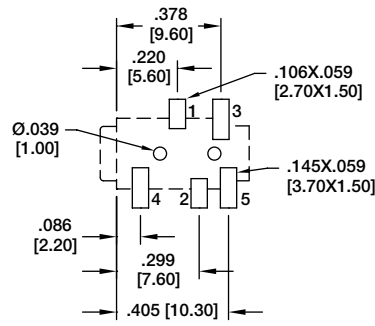
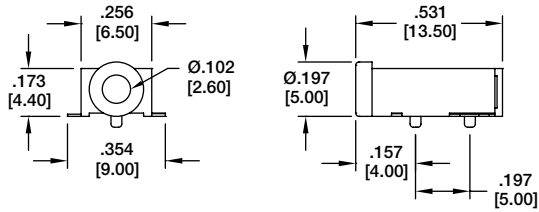

Recommended PCB Layout



ASJ-103-J

ASJ-103-J	ASJ-103-M

ASJ-104

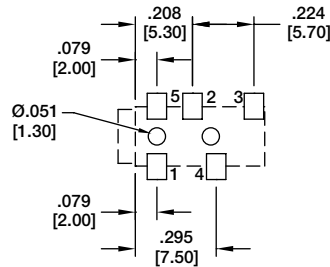
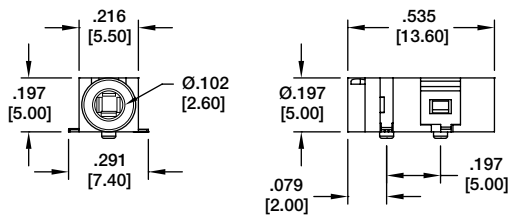

Recommended PCB Layout



ASJ-104-J

ASJ-104-J

ASJ-105

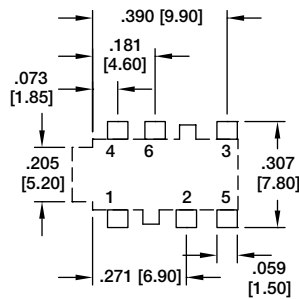
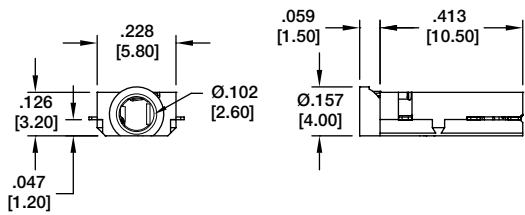

Recommended PCB Layout



ASJ-105-A

ASJ-105-A	ASJ-105-B	
ASJ-105-D	ASJ-105-M	ASJ-105-I

ASJ-106

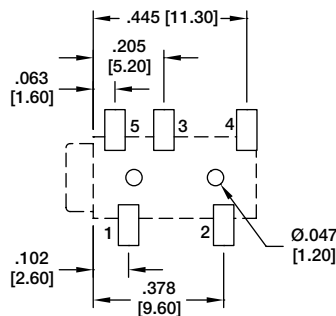
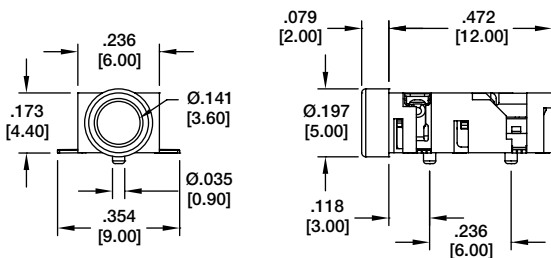

Recommended PCB Layout



ASJ-106-C

ASJ-106-C	ASJ-106-D	
ASJ-106-K	ASJ-106-P	ASJ-106-B

ASJ-107

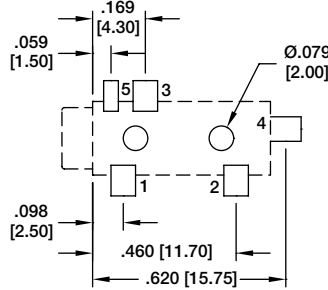
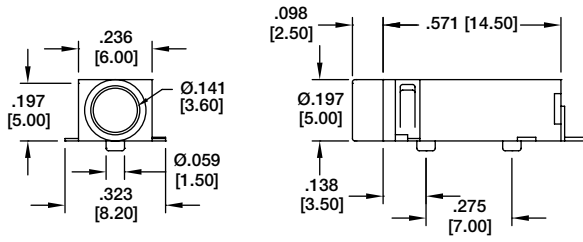

ASJ-107-B

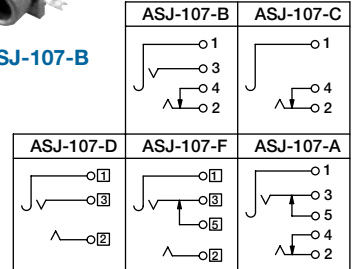

Recommended PCB Layout

ASJ-108

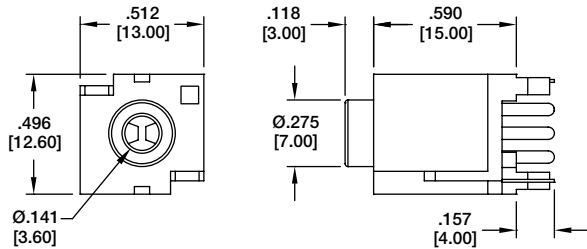

ASJ-108-A

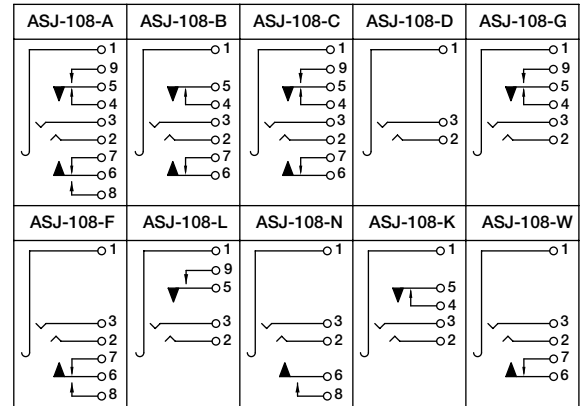

ASJ-109

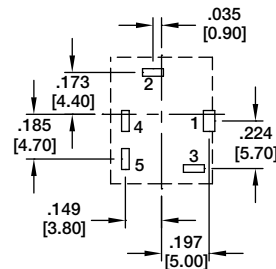
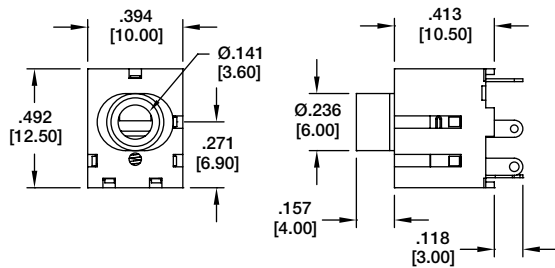

ASJ-109-A

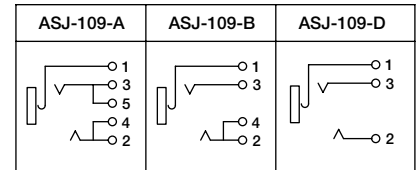

Recommended PCB Layout

ASJ-110

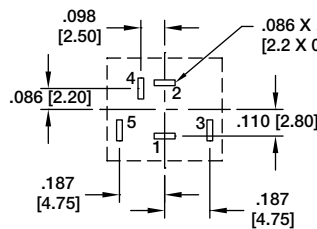
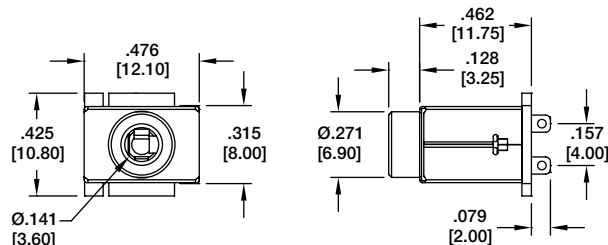

ASJ-110-A

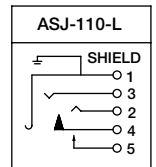

Recommended PCB Layout

ASJ-111

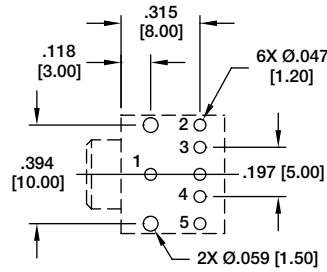
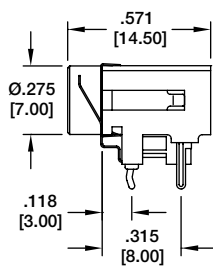
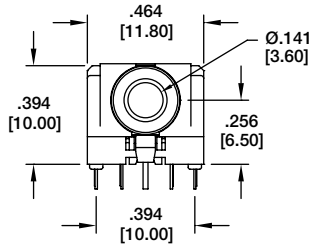

Recommended PCB Layout



ASJ-111-1

ASJ-111-1	ASJ-111-1A

ASJ-112



ASJ-112-J

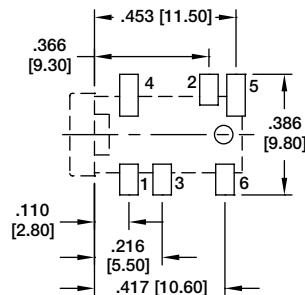
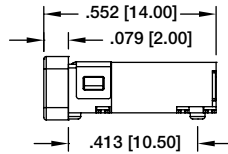
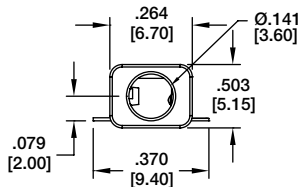

Recommended PCB Layout

ASJ-112-I	ASJ-112-J	ASJ-112-M
ASJ-112-A	ASJ-112-B	ASJ-112-D

ASJ-113



ASJ-113-B

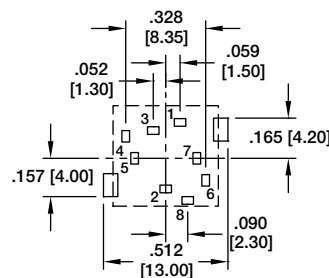
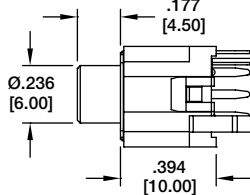
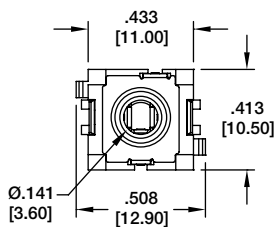

Recommended PCB Layout

ASJ-113-B	ASJ-113-D
ASJ-113-K	ASJ-113-W

MONO AUDIO PLUG

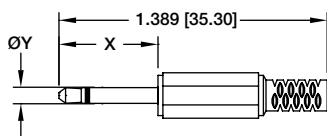

DIMENSION	X	Y
ASP-2.5-M	.468 [11.90]	Ø.098 [2.50]
ASP-3.5-M	.590 [15.00]	Ø.137 [3.50]

STEREO AUDIO PLUG 2 CHANNEL

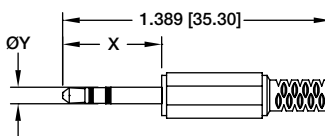

DIMENSION	X	Y
ASP-2.5-S	.468 [11.90]	Ø.098 [2.50]
ASP-3.5-S	.590 [15.00]	Ø.137 [3.50]

STEREO AUDIO PLUG 3 CHANNEL

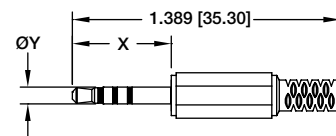

DIMENSION	X	Y
ASP-2.5-S3	.468 [11.90]	Ø.098 [2.50]
ASP-3.5-S3	.590 [15.00]	Ø.137 [3.50]