

ADC-010

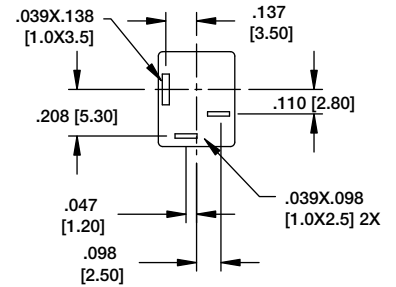

ADC-010-1

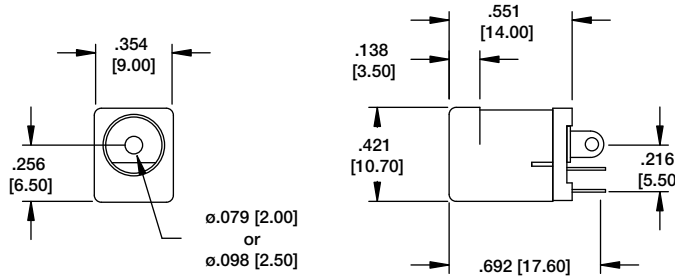

Recommended PCB Layout

ADC-015



ADC-015-2

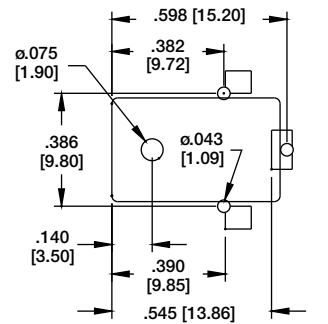
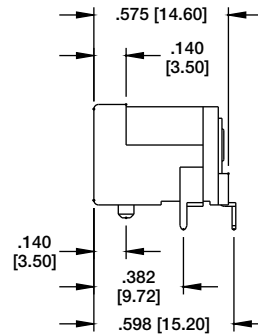
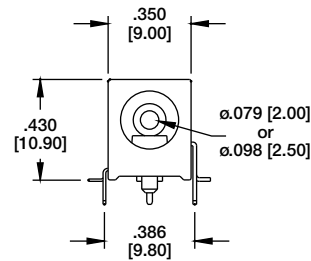

Recommended PCB Layout

ADC-045A



ADC-045A-1

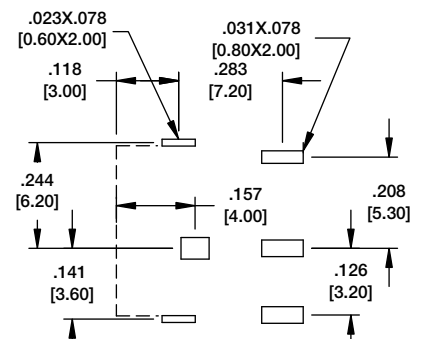
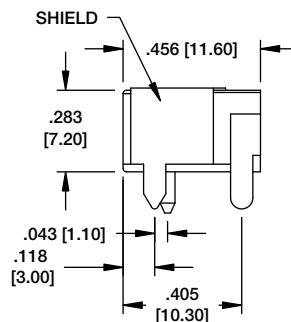
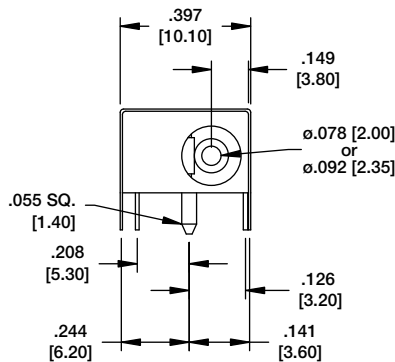

Recommended PCB Layout

ADP-PLUG WITH STRAIN RELIEF

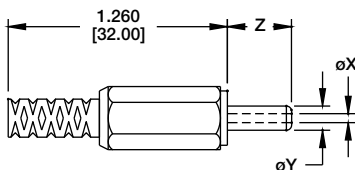

PLUG WITH STRAIN RELIEF	X	Y	Z
ADP-X/Y/Z-SR	$\phi .039$ [1.00]	$\phi .137$ [3.50]	.374 [9.50]
ADP-X/Y/Z-SR	$\phi .082$ [2.10]	$\phi .216$ [5.50]	.374 [9.50]
ADP-X/Y/Z-SR	$\phi .098$ [2.50]	$\phi .216$ [5.50]	.374 [9.50]

ADP-PLUG WITHOUT STRAIN RELIEF

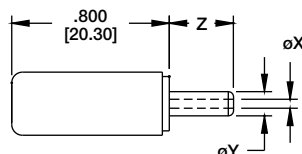

PLUG WITHOUT STRAIN RELIEF	X	Y	Z
ADP-X/Y/Z	$\phi .039$ [1.00]	$\phi .137$ [3.50]	.374 [9.50]
ADP-X/Y/Z	$\phi .082$ [2.10]	$\phi .216$ [5.50]	.374 [9.50]
ADP-X/Y/Z	$\phi .098$ [2.50]	$\phi .216$ [5.50]	.374 [9.50]