

### MINI USB 2.0, TYPE AB RIGHT ANGLE MID MOUNT TRUE SMT

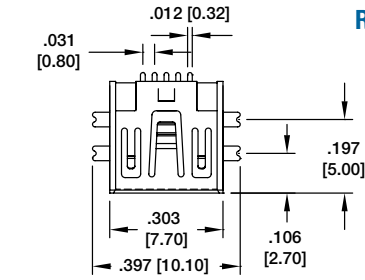

**MUSB-AB-S-RA-TSMT**

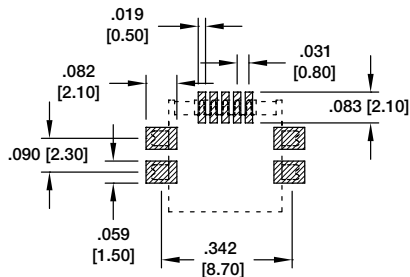
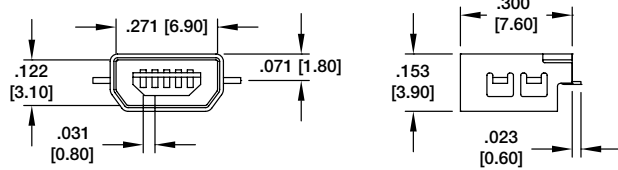

**Recommended PCB Layout**

### MINI USB 2.0, TYPE AB1 RIGHT ANGLE TRUE SMT

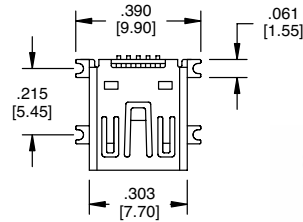

**MUSB-AB1-S-RA-TSMT**

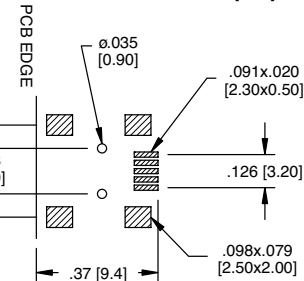
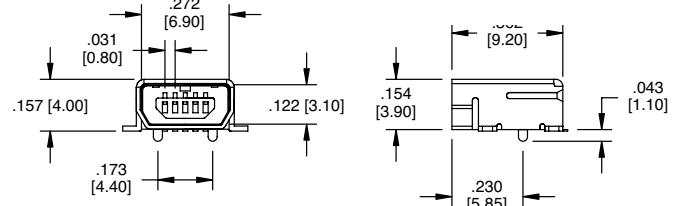

**Recommended PCB Layout**

### MINI USB 2.0, TYPE A4 RIGHT ANGLE, TRUE SMT

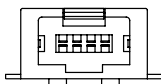
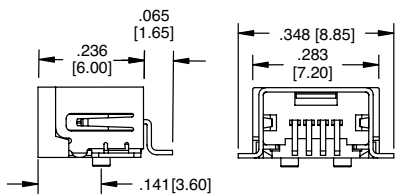

**MUSB-A4-S-RA-SMT-MK**

MIDDLE KEY



**MUSB-A4-S-RA-SMT-SK**

SINGLE KEY

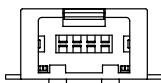

**MUSB-A4-S-RA-SMT-DK**

DUAL KEY

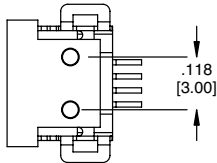

**MUSB-A4-S-RA-SMT-XX**

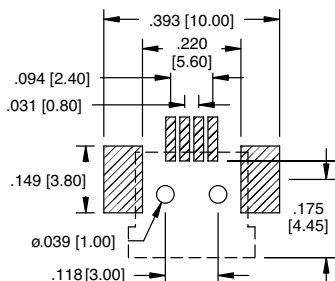

**Recommended PCB Layout**

### MINI USB 2.0, 8 PIN RIGHT ANGLE, SMT

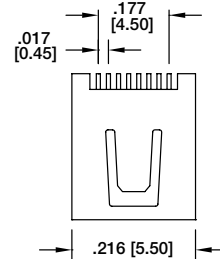

**MUSB-8P-S-RA-SMT**

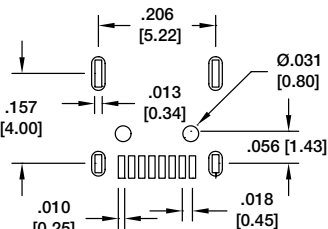
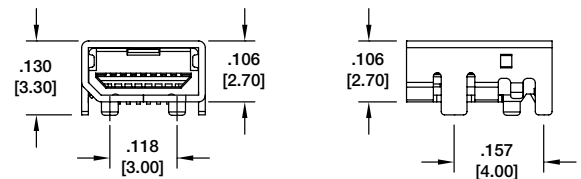

**Recommended PCB Layout**

