

USB 2.0, TYPE A RIGHT ANGLE THRU-HOLE

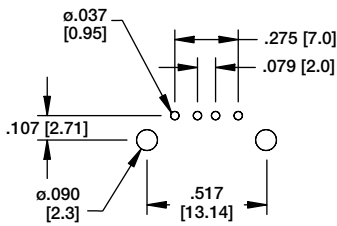

Recommended PCB Layout

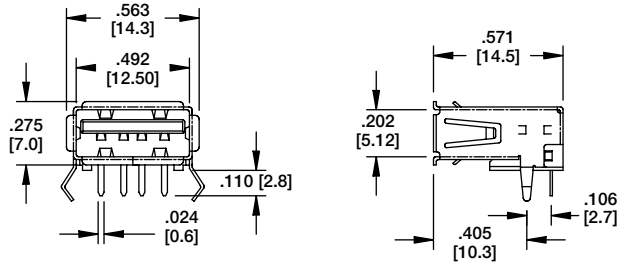

USB-A-S-RA

USB 2.0, TYPE A RIGHT ANGLE SMT

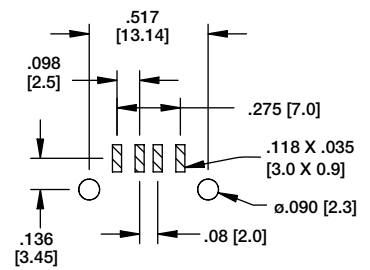
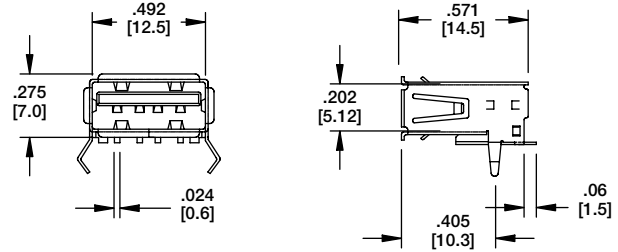

Recommended PCB Layout



USB-A-S-RA-SMT

USB 2.0, TYPE A VERTICAL THRU-HOLE

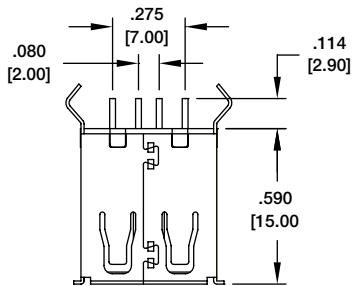

USB-A-S-VT

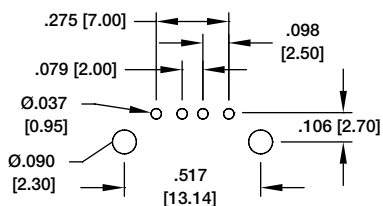
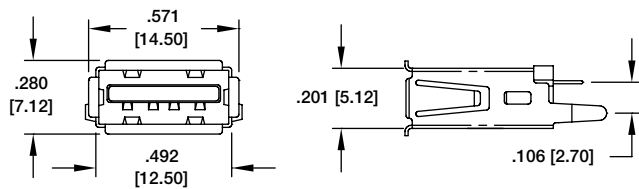

Recommended PCB Layout

USB 2.0, TYPE A RIGHT ANGLE TRUE SMT

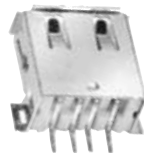

USB-A-S-RA-TSMT

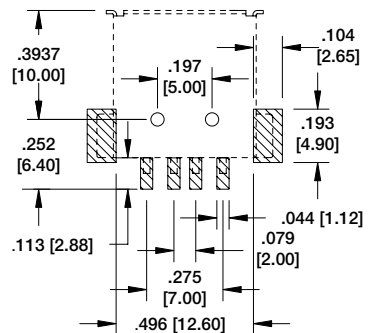
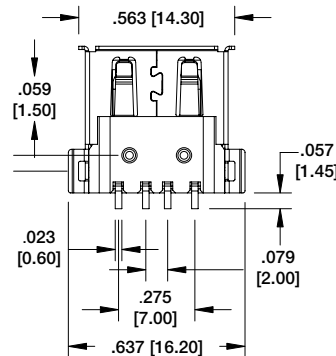
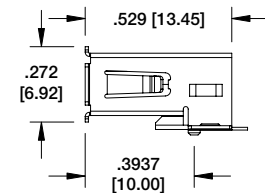
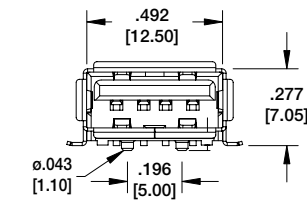

Recommended PCB Layout

USB 2.0, TYPE A ANGLE UPRIGHT, THRU-HOLE

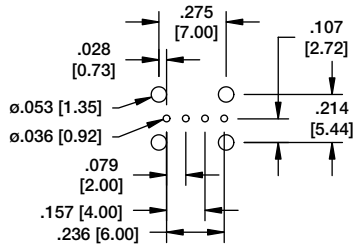
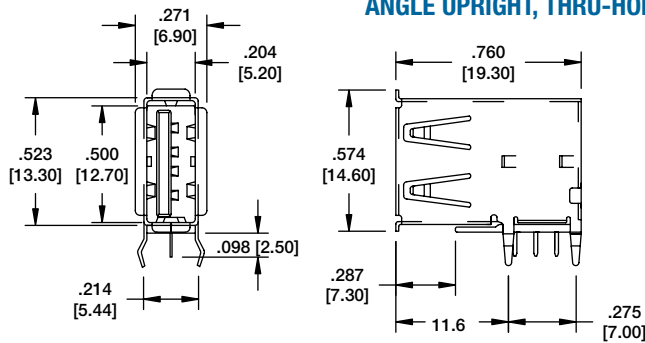

Recommended PCB Layout



USB-A-S-RU

USB 2.0, TYPE A RIGHT ANGLE, THRU-HOLE

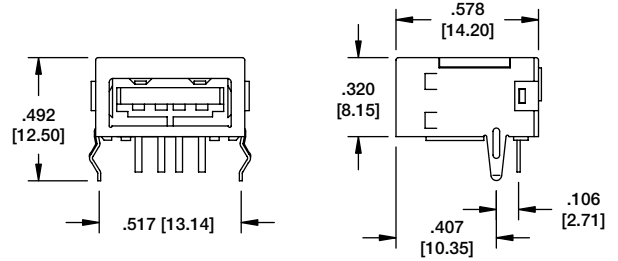

USB-A-S-RA-FS

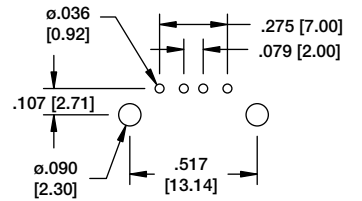

Recommended PCB Layout

USB 2.0, TYPE A PLUG RIGHT ANGLE, THRU-HOLE

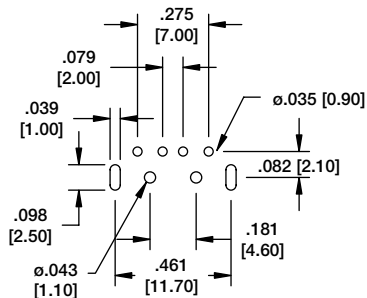
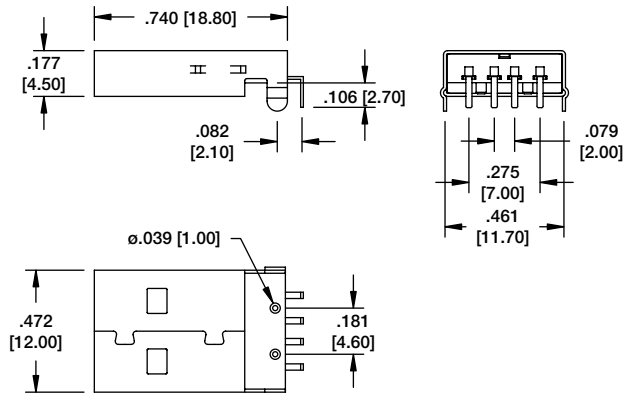

Recommended PCB Layout

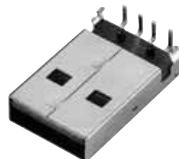

USB-AP-S-RA

USB 2.0, TYPE A PLUG RIGHT ANGLE, SMT

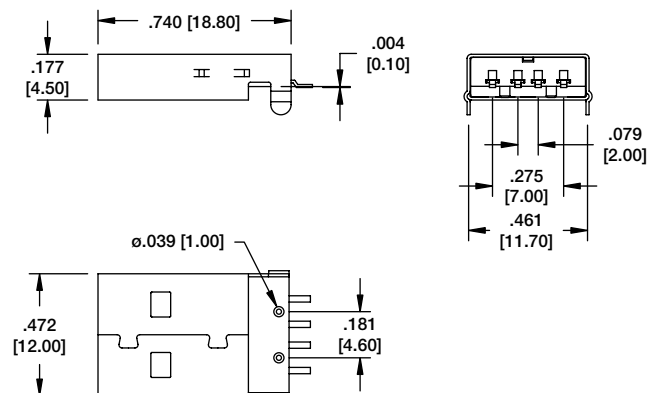

USB-AP-S-RA-SMT

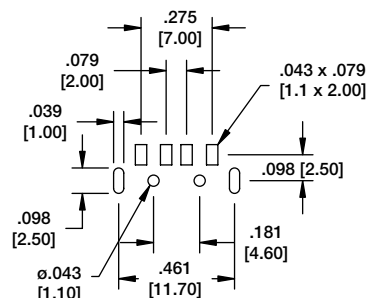

Recommended PCB Layout