

**DMF  
RIGHT ANGLE  
WITH FLANGE**

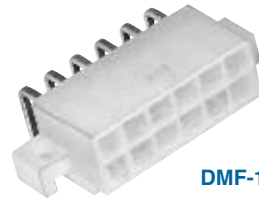

**DMF-12-R-F**

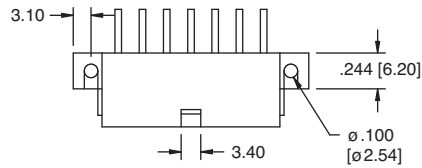
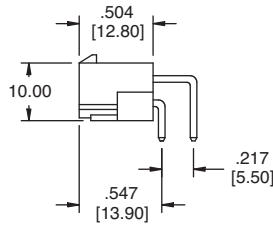
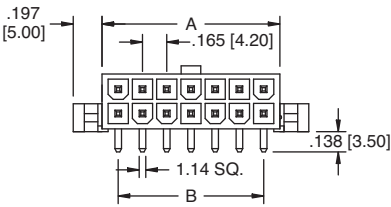

A = .165 [4.20] x No. of Positions + .213 [5.40]  
B = .165 [4.20] x No. of Spaces

**Recommended PCB Layout**

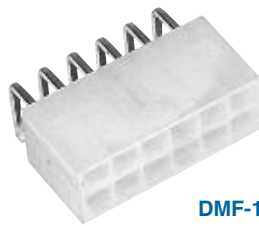
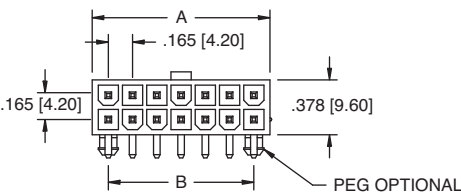
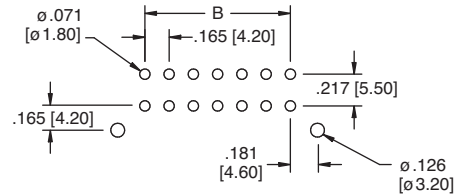

**DMF-12-R-N**

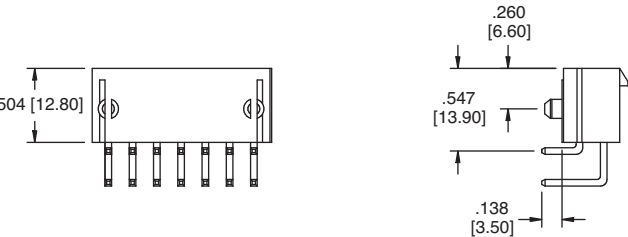

A = .165 [4.20] x No. of Positions + .213 [5.40]  
B = .165 [4.20] x No. of Spaces

**Recommended PCB Layout**

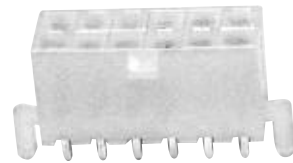
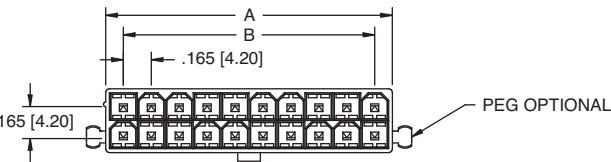
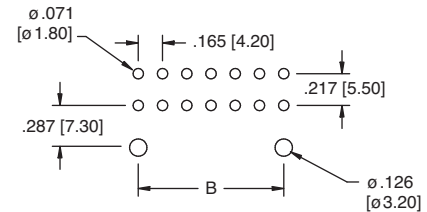

**DMF-12-S-P**

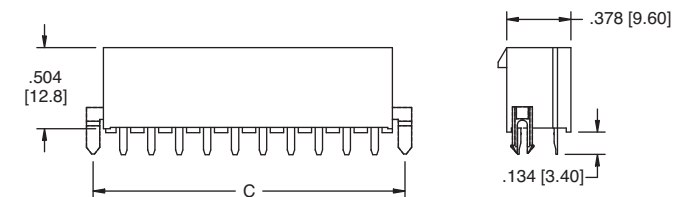

A = .165 [4.20] x No. of Positions + .213 [5.40]  
B = .165 [4.20] x No. of Spaces

**Recommended PCB Layout**

