

### DMH

#### CRIMP HOUSING

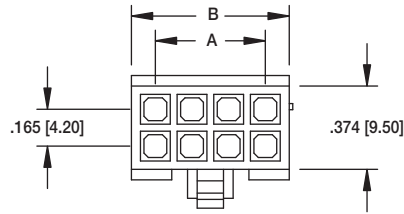

DMH-12

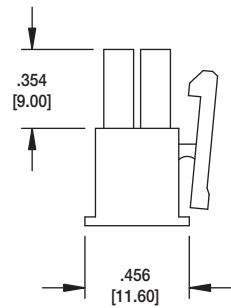
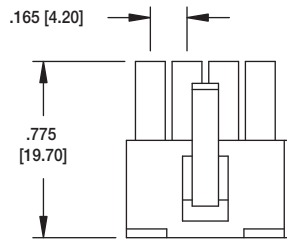

**DIMENSIONS:**

A = .165 [4.20] X No. of Position / 2 - 1

B = .165 [4.20] X No. of Positions / 2 + .055 [1.40]

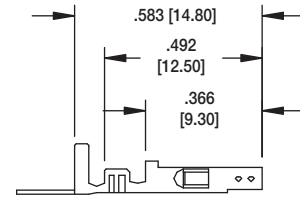
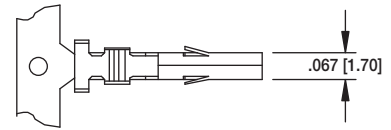

#### DMH CRIMP CONTACT

PART #	WIRE AWG
DMH-A-C-F-R	22 ~ 24
DMH-B-C-F-R	18 ~ 22
DMH-C-C-F-R	16 ~ 18

### DMF

#### CRIMP HOUSING

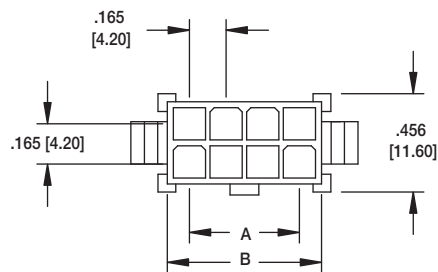

DMF-06-W



DMF-12-W

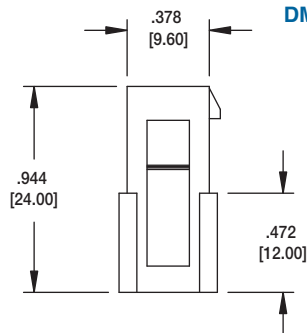

**DIMENSIONS:**

A = .165 [4.20] X No. of Position / 2 - 1

B = .165 [4.20] X No. of Positions / 2 + .055 [1.40]

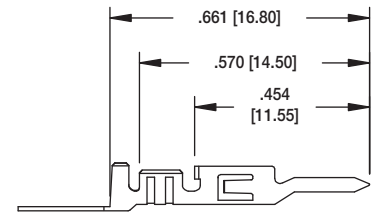
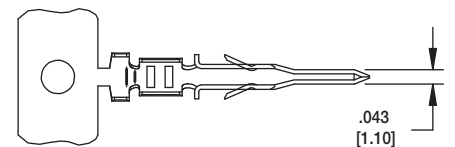

#### DMF CRIMP CONTACT

PART #	WIRE AWG
DMF-A-C-M-R	22 ~ 24
DMF-B-C-M-R	18 ~ 22

**DMF  
RIGHT ANGLE  
WITH FLANGE**

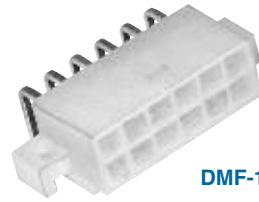
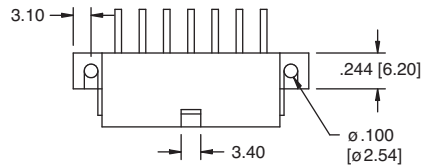

**DMF-12-R-F**

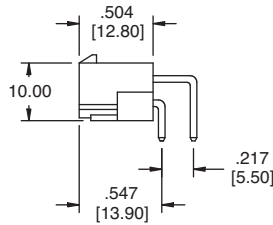
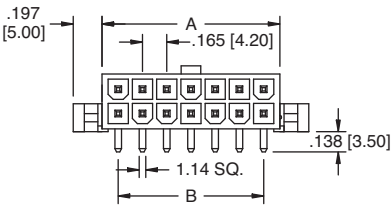

A = .165 [4.20] x No. of Positions + .213 [5.40]  
B = .165 [4.20] x No. of Spaces

**Recommended PCB Layout**

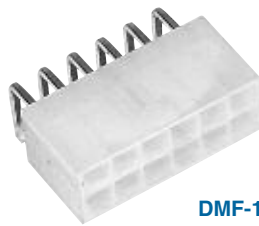
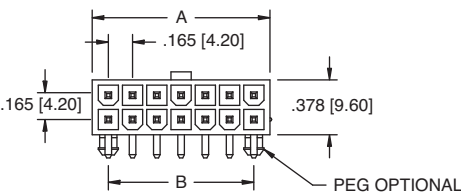
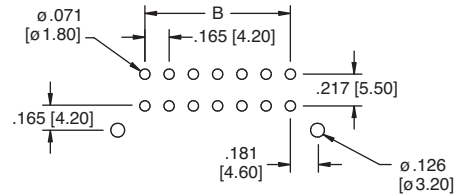

**DMF-12-R-N**

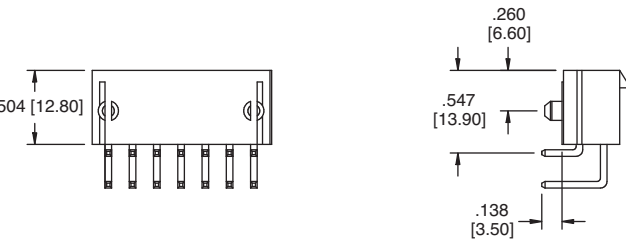

A = .165 [4.20] x No. of Positions + .213 [5.40]  
B = .165 [4.20] x No. of Spaces

**Recommended PCB Layout**

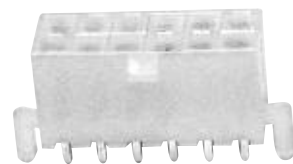
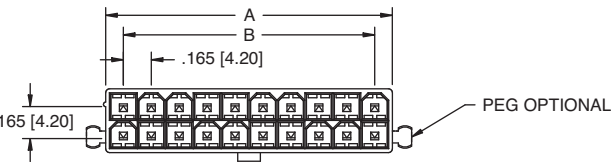
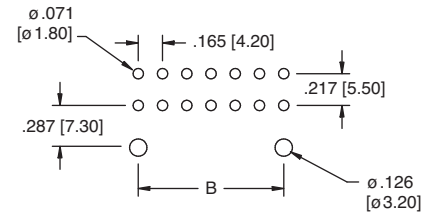

**DMF  
STRAIGHT MOUNT  
WITH PEG**

**DMF-12-S-P**

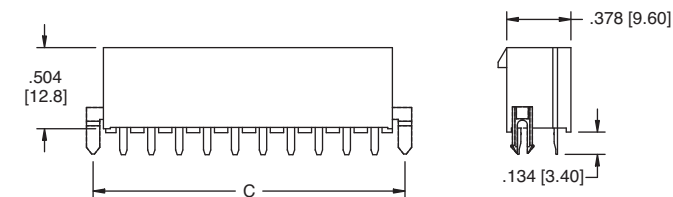

A = .165 [4.20] x No. of Positions + .213 [5.40]  
B = .165 [4.20] x No. of Spaces

**Recommended PCB Layout**

