

MHR

STRAIGHT PCB MOUNT

A = .100 [2.54] x No. of Spaces + .860 [21.84]
 B = .100 [2.54] x No. of Spaces + .460 [11.68]
 C = .100 [2.54] x No. of Spaces

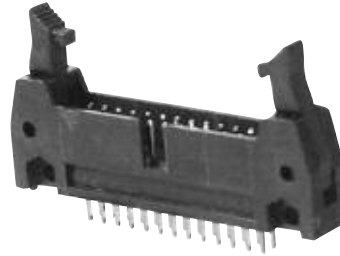
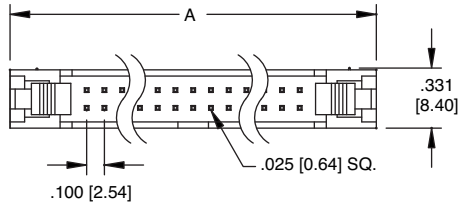

MHR-26-VUAL

Latch Options

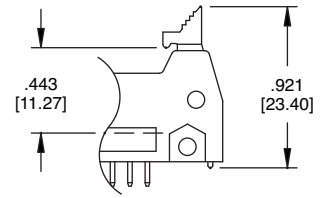

Header with Short Ejector/Latch for Sockets without Strain Reliefs

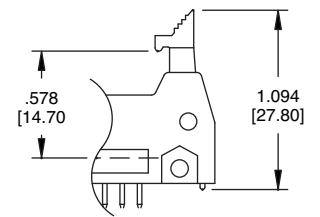

Header with Long Ejector/Latch for Sockets with Strain Reliefs

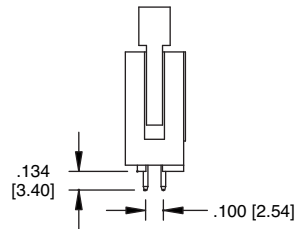
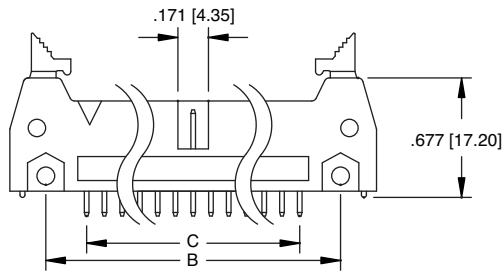

MHR
RIGHT ANGLE PCB MOUNT

A = .100 [2.54] x No. of Spaces + .860 [21.84]
 B = .100 [2.54] x No. of Spaces + .460 [11.68]
 C = .100 [2.54] x No. of Spaces

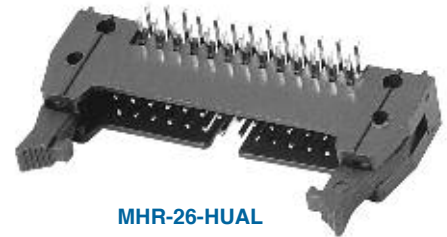
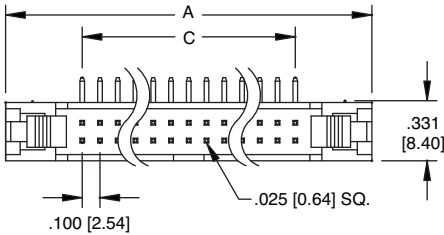

MHR-26-HUAL

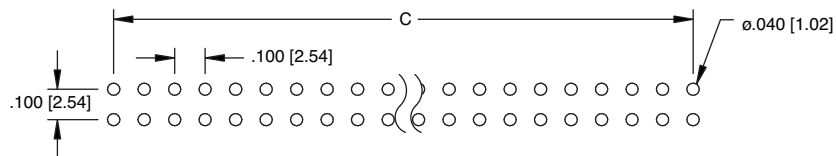
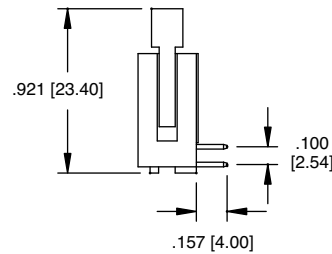
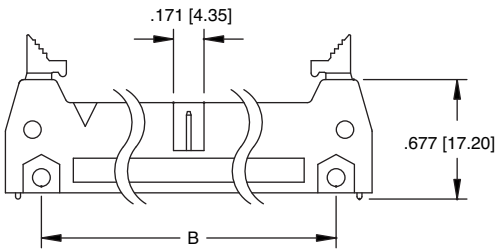

Recommended PCB Layout