

Ordering Information pg. 9

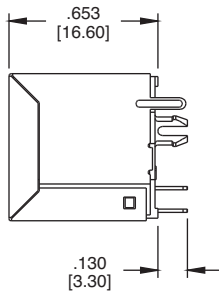
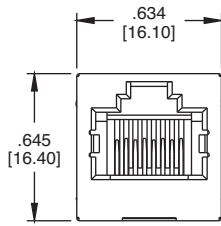

MTJ-88AX1-FSE

TYPE A
CAT. 5, TOP ENTRY
8P8C

Recommended PCB Layout

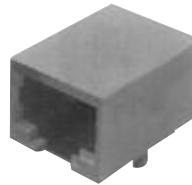
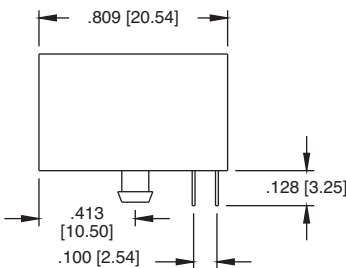
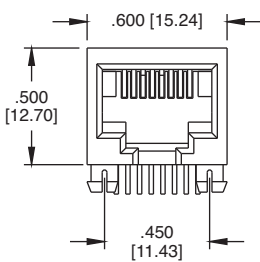
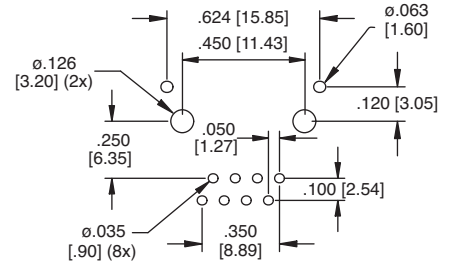

MTJ-88TX1

TYPE T
CAT. 5e, SIDE ENTRY
8P8C

Recommended PCB Layout

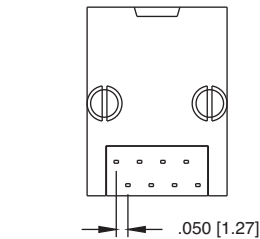
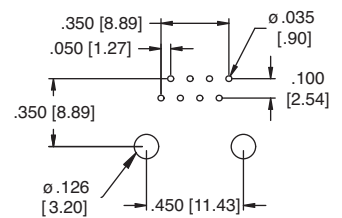

TYPE T
CAT. 5e, SHIELDED
8P8C



MTJ-88TX1-FSE-PG
Available with or without
panel ground tabs

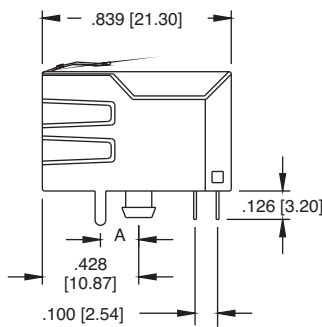
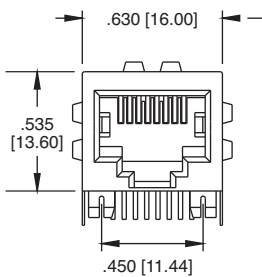

FSA, FSB & FSE

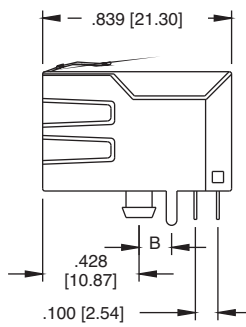

FSD = .120 [3.05]

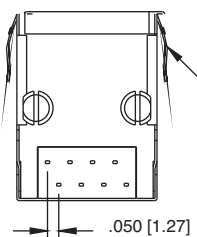

OPTIONAL
PANEL GROUND TABS

Dimensions A & B
SHIELD PIN LOCATION OPTIONS
FSA OPTION: A = .170 [4.32]
FSB OPTION: A = .144 [3.66]
FSE OPTION: A = .120 [3.05]
FSD OPTION: B = .120 [3.05]

PCB Layout (FSD)

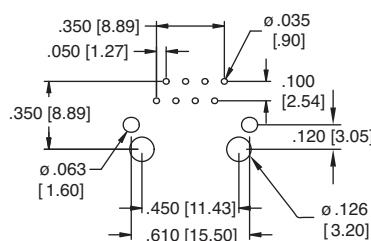

PCB Layout (FSA, FSB & FSE)

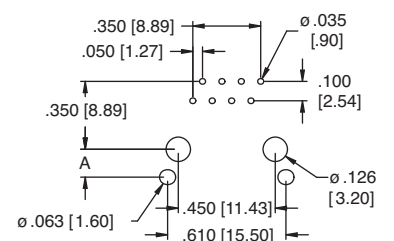

TYPE T
CAT. 5e, SHIELDED

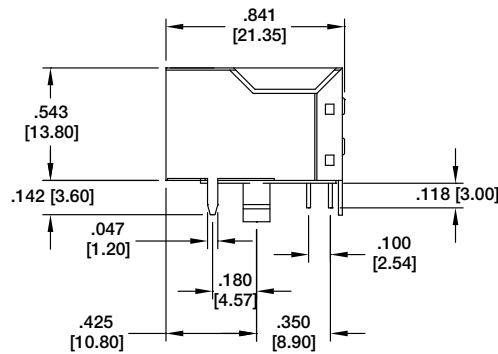
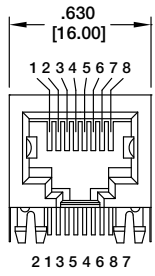

MTJ-88TX1-FSG



MTJ-88TX1-FSG-PG

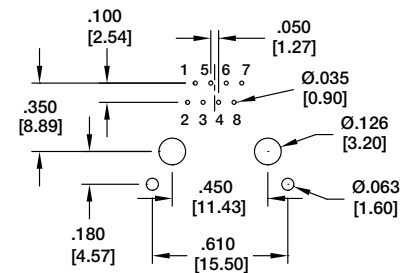
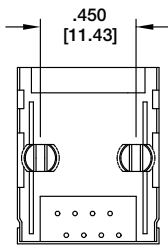

Recommended PCB Layout

TYPE T
GANGED
CAT. 5e, SHIELDED

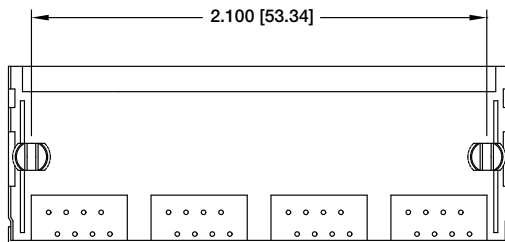
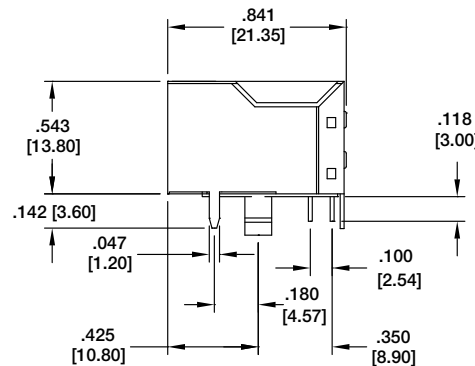
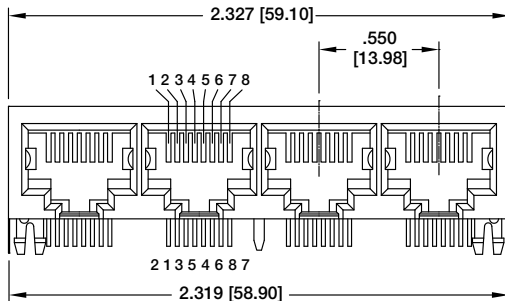

MTJG-4-88TX1-FSG

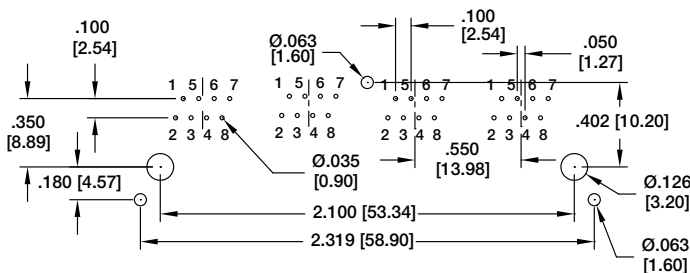

Recommended PCB Layout